



## Summary

[Request a quote](#)

[Catalog](#)

|                                    |                               |
|------------------------------------|-------------------------------|
| Low Voltage                        | 7                             |
| Wire Size/AWG                      | 32 - 24                       |
| Gender                             | Standard                      |
| Plug                               | Plug - Straight               |
| Locking system                     | Push-pull                     |
| Jacket cable outside diameter [mm] | 5.30 - 6.50 mm                |
| Size                               | 1P                            |
| Matching parts                     | <a href="#">PLG.M0.7GL.LG</a> |
| Series                             | REDEL P - Push-Pull           |

## Technical details

[https://www.lemo.com/int\\_en/solutions/redel/redel-p-push-pull/pag-m0-7gl-ac65g.html](https://www.lemo.com/int_en/solutions/redel/redel-p-push-pull/pag-m0-7gl-ac65g.html)

LEMO products and services are provided "as is". LEMO makes no warranties or representations with regard to LEMO product & services or use of them, express, implied or statutory, including for accuracy, completeness, or security. The user is fully responsible for his products and applications using LEMO components.

## Electrical Configuration

|                                       |                               |
|---------------------------------------|-------------------------------|
| Contact Termination Low voltage       | Solder                        |
| R (max)                               | 6.5 mOhm                      |
| Insert configuration value            | 1P.M07 - 7 Low Voltage        |
| Insulator                             | L: PEEK (UL 94 / V-0/1.5)     |
| Rated current                         | 5 Amps                        |
| Test voltage (kV rms) Contact-contact | 1.05                          |
| Contact Type                          | Solder                        |
| Max. Solid Conductor                  | 0.14 mm <sup>2</sup> (AWG 26) |
| Max. Stranded Conductor               | 0.14 mm <sup>2</sup> (AWG 26) |
| Air clearance                         | 0.85 mm                       |
| Creepage distance                     | 0.85 mm                       |
| Bucket Dia.                           | 0.6 mm (0.024in)              |
| Contact Dia.                          | 0.7 mm (0.0275in)             |
| Low Voltage                           | 7                             |
| Wire Size/AWG                         | 32 - 24                       |
| Gender                                | Standard                      |

## Form & Material

|                        |   |
|------------------------|---|
| Shell style / Model id | PA - Straight plug with cable collet                            |
| Plug                   | Straight  |
| Housing material       | PSU (Polysulfone), gray   |
| Locking system         | Push-pull   |
| Keying                 | 1 key (alpha=0, Plug: male contact, Receptacle: female contact) |
| Variant                | Gray collet nut   |
| Weight                 | 4.85 g  |

[https://www.lemo.com/int\\_en/solutions/redel/redel-p-push-pull/pag-m0-7gl-ac65g.html](https://www.lemo.com/int_en/solutions/redel/redel-p-push-pull/pag-m0-7gl-ac65g.html)

LEMO products and services are provided "as is". LEMO makes no warranties or representations with regard to LEMO product & services or use of them, express, implied or statutory, including for accuracy, completeness, or security. The user is fully responsible for his products and applications using LEMO components.

## Environment

|                                      |   |
|--------------------------------------|---|
| Technical domain                     | Energy and Industrial, Medical, Test and Measurement, Transportation, Aerospace and UAV |
| Environmental protection (IP rating) | IP50  |
| Minimal temperature                  | -50°C / +150°C  |
| F ret (max)                          | 150 N   |
| F ret (min)                          | 50 N  |
| Steam sterilization                  | > 100 times (with potting on rear connection)   |

## Cable fixation

|                                    |  |
|------------------------------------|--|
| Cable termination protection       | Standard back nut (no additional protection) |
| Fixation type                      | Cable collet                                 |
| Jacket cable outside diameter [mm] | 5.30 - 6.50 mm                               |

## Drawings

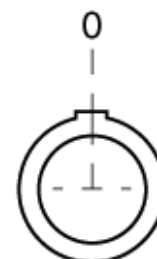
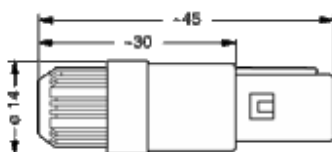

## Recommended By Lemo

### Accessories

### Tools

## Cables

| Cable PartNumber | Material | Colour | Cable image |
|------------------|----------|--------|-------------|
| 270250           | PVC      | Grey   |             |

[https://www.lemo.com/int\\_en/solutions/redel/redel-p-push-pull/pag-m0-7gl-ac65g.html](https://www.lemo.com/int_en/solutions/redel/redel-p-push-pull/pag-m0-7gl-ac65g.html)

LEMO products and services are provided "as is". LEMO makes no warranties or representations with regard to LEMO product & services or use of them, express, implied or statutory, including for accuracy, completeness, or security. The user is fully responsible for his products and applications using LEMO components.